

S:\PW_Project_Data_Management\6-PROJECTS_UPI Year_2011\11-0004-1\2 CADD\2.1 production data\drawings\Design\Exhibits\4290-PROPOSED BRIDGE EXHIBIT.dwg, LE01, 8/1/2012 9:22:46 AM, spwmfh, 1:2

SECTION 35, T. 27 N., R. 4 E., W.M.

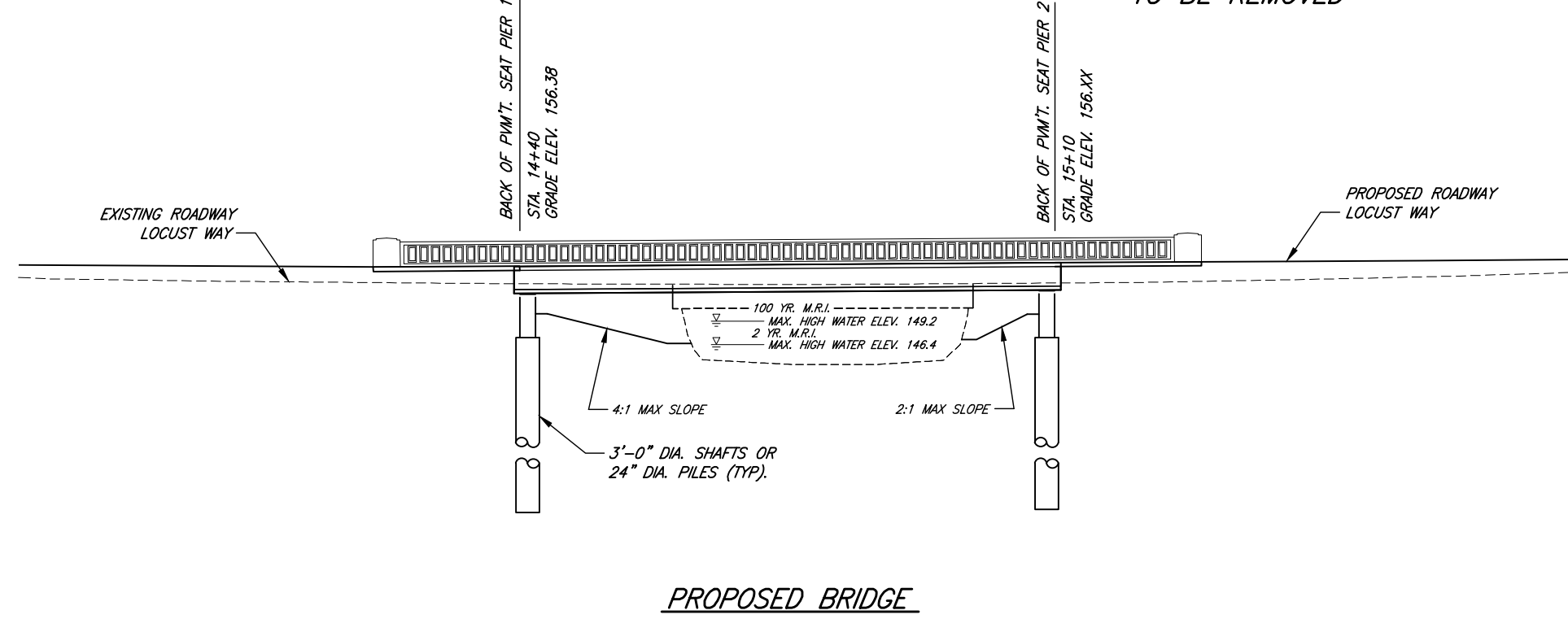
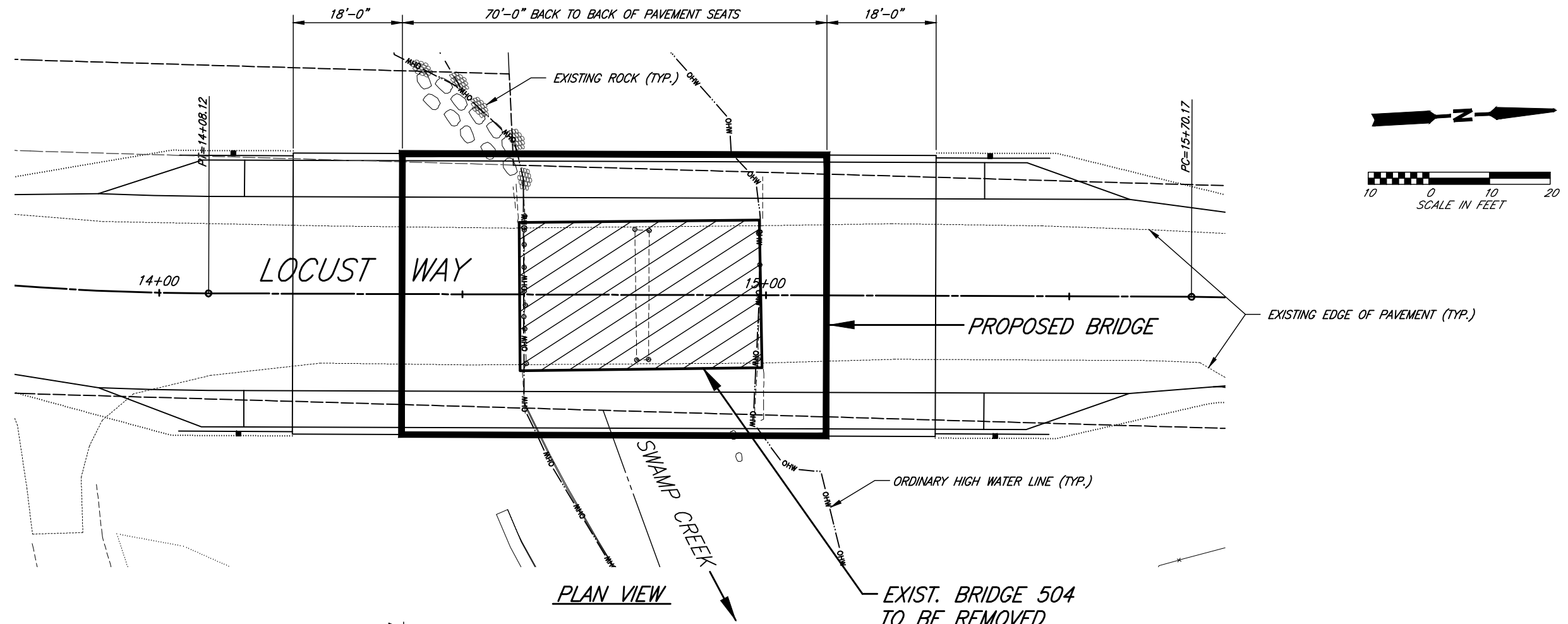

PLAN CHECK	BY	DATE	NO.	REVISION	BY

Last Saved By: spwmfh Aug 01, 2012 - 9:20am			
REGION NO.	STATE	FED. AID PROJ. NO.	SURVEY NO.
10	WASH.	BRM-2563(001)	4290
DESIGNED BY:		DRAWN BY:	
		MH	
FIELD BOOK(S):		UPI#	
		11-0004-1	

PRELIMINARY

30 PERCENT SUBMITTAL

SNOHOMISH COUNTY
DEPARTMENT OF
PUBLIC WORKS

FUNDING NO. 1633

SWAMP CREEK BRIDGE #504
REPLACEMENT PROJECT

PROPOSED BRIDGE EXHIBIT

REFERENCE SHEET NO. LEXX

SHEET 1 OF 1 SHEETS