

September 2013



1

Temporary metal walls kept two large trenches from caving in during construction.



2

A stormwater vault is being assembled in the trench shown in Photo 1.



3

The crew spent a lot of time in small and large trenches working on the drainage system and utility lines.



4

2.3 miles of curbing goes in after the 125 catch basins.

52nd Ave. W construction between 148th St. SW and 164th St. SW

Construction on the 52nd Ave. W corridor is moving along at an accelerated pace. Two large stormwater storage vaults and 4,500 feet of drainage pipes have been installed under the road. A center turn lane is being added on this mile-long section of corridor, along with retaining walls, bike lanes and sidewalks on both sides of the road. A project such as this usually takes two full construction seasons to complete. However, at the end of August one quarter of the work days had passed, and already half of the work was completed. Dry weather and closing the southbound lane have helped to accelerate progress. The project will be finished sometime during 2014, but it looks as if it could be sooner than the original October 2014 date.

The goal is to reopen the corridor to two-way traffic as soon as possible; this may be before November. The southbound lane of 52nd Ave. W has been closed between 164th St. SW and 148th St. SW since July.

We thank all area residents who, despite the disruption and frustration of construction, are following the traffic plan for the safety of everyone. Driving past a road-closed sign creates a traffic hazard, slows construction, and can result in a \$500 fine.

Communicating during construction

Updates and a link to photos are posted on the project Web page. Call us or send an email when you have questions or concerns about construction. Contact information is on the Web page and on the reverse side of this newsletter.



If you want to receive an email when new information is posted on the Web page, become a subscriber. Visit the project page (www.snoco.org, search "52nd") and follow the *eSubscribe* link, or contact us and we can add you as a subscriber. Two-hundred-ninety-eight people currently subscribe to the web page.

Current status

At press time the southbound lane of 52nd Ave. W was still closed between 148th St. SW and 164th St. SW. Only the northbound-only lane was open to traffic. The temporary stops for Community Transit Route #119 are on 48th Ave. W during the closure of the southbound lane on 52nd Ave. W.

Mail boxes

As part of the 52nd Ave. W project, the original mail boxes will be installed on the same side of the road as each home; there will be no need to cross the road to collect your mail. If you are interested in switching to a locking mail box, contact the Perrinville Post Office for information (7601 Olympic View Drive).



Crew members are knee deep in muddy water while working on a water line.

What does it take to rebuild this mile-long corridor? A look at the numbers:

- 500** pages in the construction contract
- 225** pages of detailed plan drawings
- 10,000** cubic yards of dirt excavated (approx.)
- 4,500** feet of drainage pipe laid in trenches
- 125** catch basins installed and hooked up
- 2.3** miles of curb and gutter
- 2** miles of sidewalk
- 78** ADA* ramps
- 500** concrete blocks to build 12 retaining walls
- 1,500** linear feet of retaining walls
- 40** driveway approaches to rebuild

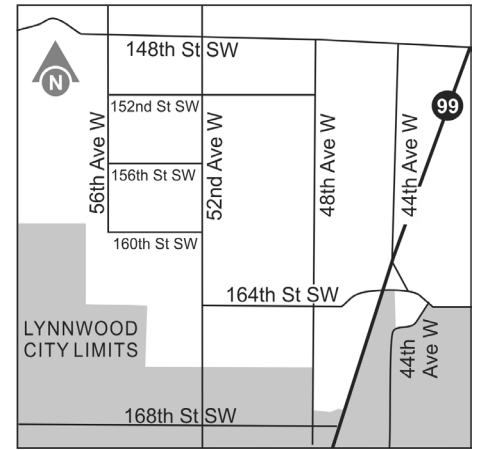

Not all roads off 52nd Ave. W are through roads. The only through roads are shown on the map above.



Snohomish County
Public Works

TES-Communications
3000 Rockefeller Ave., M/S 607
Everett, WA 98201

**Update on 52nd Ave. W
Road Improvements**

PRSR STD
US Postage
PAID
Everett, WA
Permit No. 120

Have a question or concern?

Project contact:

Tina Hokanson
Communications Specialist
Snohomish County Public Works
425-388-3789
tina.hokanson@snoco.org

Reporting:

- **Traffic issues:**
Call 9-1-1
- **Power outages:**
Snohomish County PUD,
425-783-1000

School bus info:

- Beverly Elem. School
425-431-7732
- or
- Transportation Dept.
425-431-7230

Transit info:

Community Transit
425-353-RIDE (7433)

*The Americans with Disabilities Act (ADA): Snohomish County is building and upgrading sidewalk ramps around the county to meet ADA design standards.

Interpreter and translation services for non-English speakers are available upon request. Please contact Tina Hokanson, 425-388-3789, tina.hokanson@snoco.org. Hearing/speech impaired call 711. Los servicios de traducción están disponibles bajo petición. Contacto Tina Hokanson, 425-388-3789. Las personas con impedimentos de audición y en el habla llamen al 711. 번역 서비스는 요청하시면 이용할 수 있습니다. Tina Hokanson, 425-388-3789. 로 연락하십시오. 청력/언어 장애인은 711 로 전화하십시오. Printed on recycled and recyclable paper. September 2013 (DH)